

INDUSTRIAL CONTROL

Terminal Type • 115°C Rise • Class H Insulation • 50/60 Hz

Voltage	VA	Catalog Number†	Dimensions In Inches							Dim. Fig.	Wir. DIAG.	Approx. Ship Wt. (lbs)	Max. Inrush VA @ 20% PF*	Provided W. Fuse CLIP*
			A	B	C	D	E	F	G x H					
Primary 240/480 230/460 220/440	500	636-1191-000	5.50	4.50	3.75	4.38	3.00	3.75	.203 x 1.13	10	64 A or B	11	1964	No
	750	636-1201-000	6.00	5.25	4.38	5.75	4.25	4.38	.28 x .125	10		14.5	2995	No
	1000	636-1211-000	6.75	5.25	4.38	5.75	4.25	4.38	.28 x .125	10		19	4014	No
	1500	636-1221-000	6.00	6.75	5.97	6.25	4.50	5.75	.44 x 1.50	10		24	7762	No
Secondary 120, 115, 110	2000	636-1231-000	7.50	6.75	5.97	7.12	5.38	5.75	.44 x 1.50	10		34	12100	No
	3000	636-1241-000	8.88	6.75	5.97	8.88	7.13	5.75	.44 x 1.50	10		43	17297	No
	5000	636-1261-000	10.0	9.00	7.88	7.88	6.13	7.75	.44 x .69	10		76	33000	No
Primary 208/277 Secondary 120	500	636-1196-000	5.50	4.50	3.75	4.38	3.00	3.75	.203 x 1.13	10		64C	11	1964
	750	636-1206-000	6.00	5.25	4.38	5.75	4.25	4.38	.28 x 1.25	10	14.5		2995	No
	1000	636-1216-000	6.75	5.25	4.38	5.75	4.25	4.38	.28 x 1.25	10	19		4014	No
	1500	636-1226-000	6.00	6.75	5.97	6.25	4.50	5.75	.44 x 1.50	10	24		7762	No
	2000	636-1236-000	7.50	6.75	5.97	7.12	5.38	5.75	.44 x 1.50	10	34		12100	No
	3000	636-1246-000	8.88	6.75	5.97	8.88	7.13	5.75	.44 x 1.50	10	43		17297	No
Primary 415/600 400/575 380/550, 500 Secondary 120, 115, 110, 100	500	636-1198-000	5.50	4.50	3.75	4.38	3.00	3.75	.203 x 1.13	10	64D	11	1964	No
	750	636-1208-000	6.00	5.25	4.38	5.75	4.25	4.38	.28 x 1.25	10		14.5	2995	No
	1000	636-1218-000	6.75	5.25	4.38	5.75	4.25	4.38	.28 x 1.25	10		19	4014	No
	1500	636-1228-000	6.00	6.75	5.97	6.25	4.50	5.75	.44 x 1.50	10		24	7762	No
	2000	636-1238-000	7.50	6.75	5.97	7.12	5.38	5.75	.44 x 1.50	10		34	12100	No
	3000	636-1248-000	8.88	6.75	5.97	8.88	7.13	5.75	.44 x 1.50	10		43	17297	No
	5000	636-1268-000	10.0	9.00	7.88	7.88	6.13	7.75	.44 x .69	10		76	33000	No

† 2-pole suffix = 200 / 3-pole suffix = 300 / finger-safe terminal suffix = 400

NOTE:

200 Series – 2-pole, primary fuse block on top adds 1.25" to dimension "C"
300 Series – 3-pole, primary and secondary fuse block on top adds 1.25" to dimension "C"
400 Series – finger-safe terminal block on top adds .88" to dimension "C" – CE marked
 Dimension "D" does not apply to 400 Series transformer.

Mounting dimensions subject to change without notice. Contact factory for dimension verification where it is critical.

Figure 10

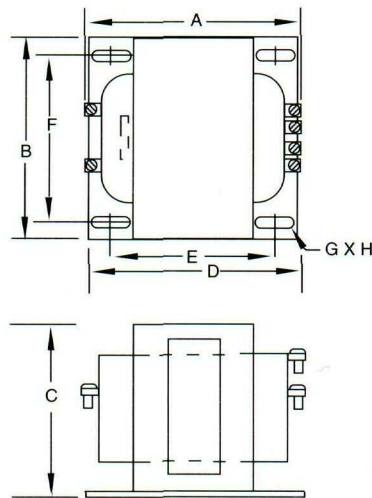

JEFFERSON®

Industrial Control Transformers

50 VA to 5 KVA

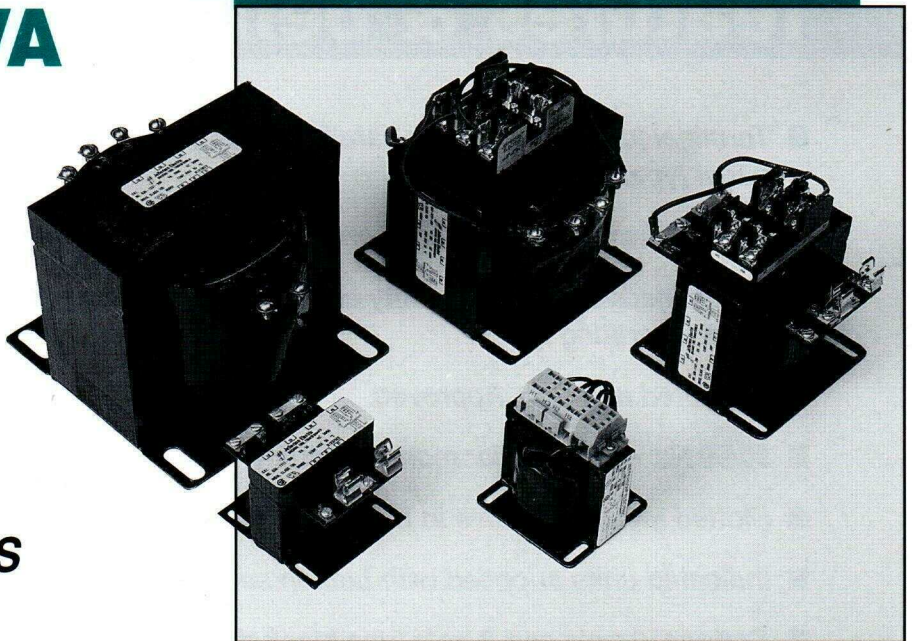

TYPICAL APPLICATIONS

- *Control panels*
- *Conveyor systems*
- *Machine tooling equipment*
- *Commercial sewing machines*
- *Pumping system panels*
- *Commercial air conditioning*

For the name of your local representative, or for technical assistance, call

1-800-892-3755

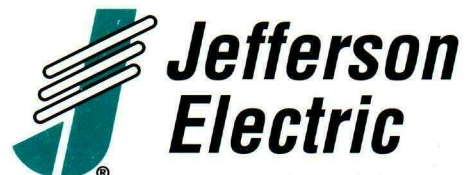

Industrial Control Transformers

features & benefits

- *Terminal jumpers for quick parallel/series connections on the dual windings panel type.*
- *Machine wound copper coils ensure long life and dependable operation.*
- *Cores made from high quality electrical steel for increased efficiency and lower operating costs.*
- *UL Listed and CSA Approved.*
- *50/60 Hz. operation for more versatility.*
- *Slotted mounting holes in base plate for quick and easy mounting.*
- *Indicated units supplied with built-in secondary fuse clip.*
- *Optional 2-pole and 3-pole fuse block designs (200/300 Series) to save space in your panels.*
- *Standard and high inrush designs for satisfactory operation of relays, contacts and solenoids.*
- *Excellent secondary voltage regulation.*
- *Optional finger-safe terminal design (400 Series) with CE mark for European use.*
- *Wiring diagram permanently affixed to transformer to avoid loss.*
- *Meets or exceeds all applicable NEMA, ANSI, OSHA, UL and CSA requirements.*
- *Made in U.S.A.*